

SYMBOL LEGEND

- T PURGE END (OCB 204/704)
- A ANODE (OCB 819/814)
- L LATERAL TEE (OCB 210, 21-33, 720, 721)
- P PRESSURE CHNL. FTG. (OCB 210/36/34)
- T TRANSITION FITTING (OCB 703)
- V VALVE - GENERAL
- R REDUCER (GMS 306 & 330)
- C CINS. COUPLING (ECT)
- W WHISTLE (GMS 8302, 3, 4)
- D DUAL 8" X 8" VAULT
- CUT AND CAP (OCB 848)
- R RETIRE MAIN (OCB 840)
- E EXCAVATE AREA (OCB 870)
- TREE
- I INSULATOR FLANGE
- E ELECTRICAL TEST STATION
- R REGULATOR STATION
- BORE PIT/TAP HOLE & SPOIL PILE W/SILT FENCE
- FLOODPLAIN

TEST SECTION	DESCRIPTION				LEAK TEST PER GCS 887			STRENGTH TEST PER GCS 888				WELD INSPECTION PER GCS 861			FIELD RECORD PER GCS 880							
	SECTION	MOP	TYPE	TOTAL LENGTH	DIA.	MAT'L	PAGE	TEST PRESSURE (PSI)	PRIOR TO STRENGTH	CONSTR. W/ STRENGTH	MIN. HOURS	TEST PRESSURE (PSI)	% DAYS AT TEST	TEST MEDIUM	ALLOWABLE WATER LOSS (GALLONS)	MIN. HOURS	VISUAL	RADIOGRAPHIC (X)	OTHERS	SECTION	DIA.	PIPE IDENTIFICATION DATA CODE - STEEL MAIN ONLY
A	60	1	1221'	2"	PE	3-5	90	-	-	2							X	-		A	2"	
B	60	1	1974'	6"	PE	14-16, 20-21	90	-	-	19							X	-		B	6"	
C	60	1	2959'	2"	PE	6-8, 11-14	90	-	-	4							X	-		C	2"	
D	60	1	355'	2"	PE	14, 17	90	-	-	1							X	-		D	2"	
E	60	1	1925'	2"	PE	8-10, 16	90	-	-	3							X	-		E	2"	
F	60	1	1519'	2"	PE	17-20	90	-	-	2							X	-		F	2"	
G	60	1	85'	2"	PE	10	90	-	-	1							X	-		G	2"	
H	60	1	5'	2"	PE	21	90	-	-	1							X	-		H	2"	

SITE PLAN
(NTS)

APPROVED FOR CONSTRUCTION

PREPARED BY: **MILHOUSE**

COUNTY	TOWNSHIP	DATE	1/2 SECTION
COOK	LYNDEN	12E 3PM	322
CITY	TOWN		
NORTHLAKE	ADN		
PROJECT	CONSTRUCTION	DATE	12-16-19
METRO	CONSTRUCTION	DATE	12-16-19
WORK ORDER NO.	DESIGNED BY	CHECKED BY	DATE
120002/SPT/AC2	A. STEARNS	A. ZEPPIERI	01-31-20
DATE	APPROVED BY	DATE	02-11-20
01-31-20	M. MILHOUSE	02-20-20	
SCALE	TERMINAL NO.	DATE IN SERVICE	SHEET NO. OF 20
1"=50'	C15322A		

NICOR GAS - CONSTRUCTION

VINTAGE STEEL REPLACEMENT - VW180

E DICKENS AVENUE, E MAJOR DRIVE, VILLAGE DRIVE, (N ROY AVENUE TO GENEVA AVENUE)

NORTHLAKE, IL

W.O. 120407/320407

INVESTING in ILLINOIS
A Nicor Gas System Improvement Initiative

- GENERAL NOTES:**
- CONTRACTOR TO INSTALL THE PROPOSED GAS MAIN TO THE ELEVATIONS SHOWN ON THE PLANS USING THE BENCHMARKS PROVIDED. APPROXIMATE COVER SHOWN AFTER THE REQUIRED ELEVATION IS FOR INFORMATION PURPOSES ONLY.
 - BACKFILL WITH SAND WHERE PIPE TRENCH IS UNDER OR WITHIN 2' OF PAVEMENT, CURB, OR SIDEWALK.
 - INSTALL PROPOSED MAIN USING ROAD STATIONING WHERE GIVEN. OTHER DIMENSIONS ARE FOR MAPPING PURPOSES ONLY.
 - ALL RIGHT-OF-WAY MUST BE STAKED AND STATIONING PROVIDED BEFORE GAS MAIN CAN BE INSTALLED.
 - INSTALL PIPELINE MARKERS PER GCS 249. SEE SPECIFICATION FOR ALL REQUIREMENTS. FOR CLASS 1 AND 2 LOCATIONS, MARKERS ARE REQUIRED OVER EACH BURIED MAIN AT EACH CROSSING OF A PUBLIC ROAD AND RAILROAD. IN ADDITION, PIPELINE MARKERS ARE REQUIRED AT ALL RAILROAD AND WATERWAY CROSSINGS.
 - INSTALL ALL MAIN WITH A MINIMUM COVER OF 3' UNLESS OTHERWISE NOTED.
 - PIPE CONTRACTOR SHALL INSTALL THE PROPOSED GAS MAINS CROSSING CONCRETE, ASPHALT, MACADAM, OR OTHER HARD SURFACED PAVEMENTS, WALKS, OR DRIVEWAYS BY BORING OR PUSHING UNLESS OTHERWISE SPECIFIED. CONTRACTOR SHALL INSTALL A TEMPORARY PATCH PER GAS CONSTRUCTION SPECIFICATIONS FOR CONTRACTORS. PERMANENT REPAIRS TO BE COMPLETED BY OTHERS.
 - CONTRACTOR SHALL FURNISH AND INSTALL ALL CAPS AND OTHER FITTINGS NECESSARY FOR TESTING THE MAIN.
 - ALL 8" AND LARGER STEEL PIPE THAT IS BORED MUST BE DUAL COATED.
 - PLUG AND/OR CAP RETIRED 6" AND LARGER MAINS EVERY 660' PER GCS 849.
 - RETIRED OLD MAIN PER GCS 849.
 - IT IS THE RESPONSIBILITY OF THE NICOR GAS INSPECTOR, CONTRACTOR, AND ANYONE INVOLVED IN THE CONSTRUCTION OF THE FACILITIES TO FOLLOW THE LATEST NICOR GAS GMS AND GCS SPECIFICATIONS. CONTACT NICOR'S TECHNICAL SERVICES DEPARTMENT FOR A COPY OF THE LATEST EDITION.
 - COORDINATE WITH NICOR GAS INSPECTOR FOR LOCATION OF UNDERGROUND UTILITIES PRIOR TO STARTING ANY EXCAVATION. EXERCISE CARE WHEN EXCAVATING NEAR EXISTING STRUCTURES.
 - ANY PROPOSED DIRECTIONALLY BORED PIPE TO BE INSTALLED PER NICOR GAS DIRECTIONAL BORING GUIDELINES DATED DECEMBER 15, 2009.
 - UTILITY LOCATIONS SHOWN ON PLANS ARE APPROXIMATE AND MAY NOT BE ALL INCLUSIVE. CONTRACTOR SHALL CONTACT J.U.L.I.E. AND LOCAL GOVERNMENT AGENCIES PRIOR TO CONSTRUCTION FOR ALL UTILITY LOCATIONS.
 - REMOVE TOP SECTION OF THE VALVE BOX FROM VALVES ON THE RETIRED MAIN. BACKFILL WITH SAND AND MATCH EXISTING PAVEMENT IF APPLICABLE.
 - IT IS THE RESPONSIBILITY OF THE CREW (INTERNAL OR CONTRACTOR) INSTALLING THE GAS FACILITIES TO LOCATE ALL SEWER MAINS AND LATERALS WITHIN THE SCOPE OF THE PROJECT. NO BORING, DIRECTIONAL DRILLING OR OTHER TRENCHLESS CONSTRUCTION METHODS SHALL BE EMPLOYED WITHOUT EITHER LOCATING SEWERS OR OBTAINING PROOF OF SEPTIC SYSTEMS. THE USE OF A SONDE DEVICE (CALIBRATED DAILY) IS RECOMMENDED FOR LOCATING THE SEWER FACILITIES. SPOTTING OF SEWER FACILITIES IS REQUIRED IF A SONDE DEVICE IS NOT USED (HOWEVER, SPOTTING OF SEWER MAINS/LATERALS SHALL BE MAINTAINED PER GCS 700 SECTION 10).
- CONTACT INFO:**
FRANK TAVAZZO
NICOR CONSTRUCTION OPERATIONS SUPERINTENDENT
PHONE: (815) 261-9418
EMAIL: FTAVAZZ@SOUTHERNECO.COM
- DALE ROBERTS
CITY OF NORTHLAKE PUBLIC WORKS SUPERINTENDENT
PHONE: (708) 562-0940
EMAIL: DROBERTS@NORTHLAKECITY.COM

- ENVIRONMENTAL NOTES:**
- PCB WIPE SAMPLES, PERFORMED BY NICOR GAS EMPLOYEES, ARE REQUIRED FOR ALL 4" AND LARGER PIPE THAT IS ABANDONED OR REMOVED ON THIS WORK ORDER. DIRECT QUESTIONS ON PCB WIPE SAMPLE PROCEDURES TO THE SYSTEM OPERATIONS DEPARTMENT OR KEITH BOGGER (630-514-7589) IN ENVIRONMENTAL AFFAIRS (EA).
 - COLLECT AND PROPERLY DISPOSE OF ALL LIQUIDS FROM PIPELINES BEING RETIRED.
 - IN THE EVENT OF A SPILL, PLEASE IMMEDIATELY CALL DISPATCH (630-317-9111) AND ASK FOR THE ON-CALL ENVIRONMENTAL REPRESENTATIVE.
 - ANY RETIRED PIPE THAT MUST BE REMOVED FROM THE SITE SHOULD HAVE THE ENDS COVERED WITH PLASTIC OR SIMILAR MATERIAL UNTIL THE PCB WIPE SAMPLE LAB RESULTS ARE KNOWN. INDICATE ON THE "NICOR GAS PCB SAMPLE INFORMATION FORM" WHERE ANY PIPE REMOVED FROM THE SITE IS BEING TEMPORARILY LOCATED.
 - IF ASBESTOS COAL WRAP IS IDENTIFIED, REFER TO ASBESTOS COAL WRAP REMOVAL GUIDELINES. REMOVAL MUST BE COMPLETED BY A TRAINED EMPLOYEE. FOR ANY QUESTIONS OF PROCEDURE OR TRAINED EMPLOYEES, CALL SCOTT MURPHY (630-392-7033) IN THE SAFETY DEPT.
 - IF CONTAMINATED SOIL IS SUSPECTED, CALL KEITH BOGGER (630-514-7589) IN EA FOR REGULATORY COMPLIANCE INSTRUCTION.
 - ALL WETLANDS SHOULD BE IDENTIFIED ON THESE WORK ORDER DRAWINGS. WETLANDS AND WATERBODIES ARE GENERALLY LABELED AS "SITES". IF THERE IS A QUESTION ABOUT THE WETLAND BOUNDARIES OR BUFFERS, PLEASE CALL EA (JULIE PASCHAL AT 630-392-7013 OR ALICIA BISHOP 224-268-7283).
 - IF THE PROJECT HAS ENVIRONMENTAL PERMITS AND/OR A GREEN BINDER, THE CONTRACTOR IS RESPONSIBLE FOR FOLLOWING THE NICOR GAS STORED WATER POLLUTION PREVENTION PLAN FOR THE PROJECT. IF THERE ARE QUESTIONS, PLEASE CALL EA (JULIE PASCHAL AT 630-392-7013 OR ALICIA BISHOP 224-268-7283).
 - IF A FRAC OUT OCCURS DURING DIRECTIONAL DRILLING, THE CONTRACTOR IS RESPONSIBLE FOR STOPPING THE BORE, CONTAINING THE FRAC OUT MATERIAL, AND IMMEDIATELY CONTACTING EA (JULIE PASCHAL AT 630-392-7013 OR ALICIA BISHOP 224-268-7283). AFTER CONTAINING THE MATERIAL AND CONTACTING EA, THE CONTRACTOR MUST REMOVE THE FRAC OUT MATERIAL.
 - REFUEL AND STORE EQUIPMENT A MINIMUM OF 100 FEET FROM WETLANDS OR WATER BODIES.
 - INSTALL SOIL AND EROSION CONTROL PROTECTION TO PROTECT ANY OPEN CRATED STRUCTURES, I.E. INLETS, CATCH BASINS, OR MANHOLES WITHIN OR ADJACENT TO THE PROJECT AREA THAT ARE NEAR DISTURBED SOIL.
 - WHEN DEWATERING, DIRECT WATER TO A FLAT, UPLAND AREA TO ALLOW WATER TO SOAK INTO THE GROUND AND/OR USE FILTER BAGS AND WOOD FIBER LOGS TO REMOVE SOIL/SEDIMENT FROM THE WATER. NO SEDIMENT LADEN WATER IS ALLOWED TO ENTER WETLANDS, WATER BODIES, ETC.
 - IF MUD IS BEING TRACKED ON THE STREETS BY EQUIPMENT AND/OR VEHICLES, DAILY STREET SWEEPING WILL BE REQUIRED.
 - ALL DISTURBED AREAS SHALL BE RESTORED TO ORIGINAL CONTOURS AND CONDITIONS. RESTORATION MUST BE INITIATED WITHIN 1 DAY DEPENDING ON PERMIT CONDITIONS.

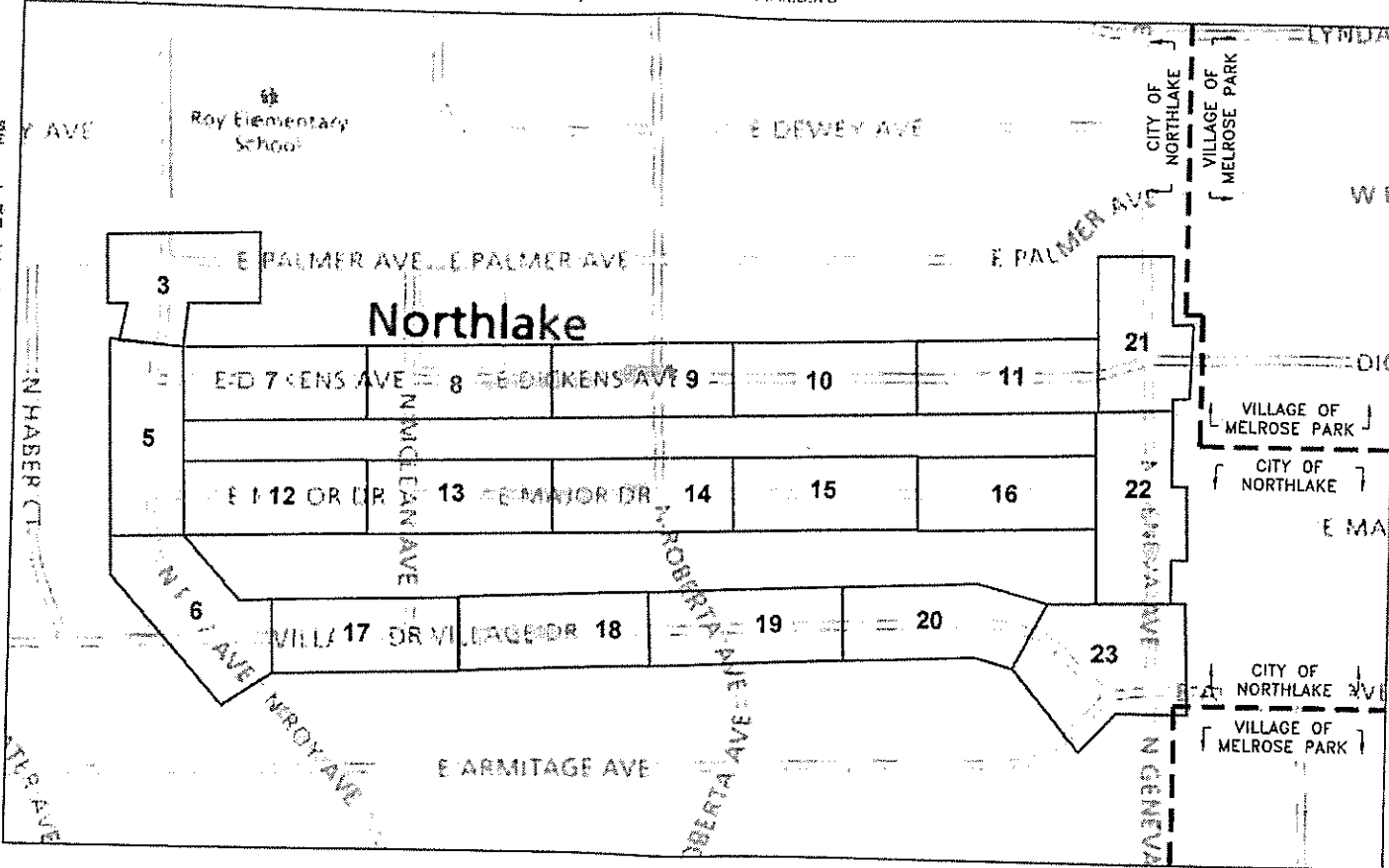

IDENTIFIED BY NICOR UTILITY INSPECTOR				COMPLETED BY NICOR GAS*		
WIPE TEST #	WORK ORDER PAGE	TEST LOCATION	PIPE SIZE	PIPE MATERIAL	DATE TEST COMPLETED	COMMENTS

*TYPICALLY COMPLETED BY UTILITY INSPECTOR

NOTE: NICOR UTILITY INSPECTOR TO IDENTIFY TEST LOCATIONS BASED UPON THE CRITERION OF ONE TEST FOR EACH "CUT AND CAP" ON PIPE THAT MEASURES FOUR INCHES IN DIAMETER OR GREATER. NICOR GAS UNDERSTANDS THAT FIELD PERSONNEL MAY DECIDE TO MOVE "CUT AND CAP" LOCATIONS, DELETE "CUT AND CAPS", OR CONDUCT ADDITIONAL "CUT AND CAPS". NICOR GAS WILL INCLUDE WIPE TESTS AS PART OF THEIR ROUTINES TO COMPLETE A "CUT AND CAP" AND IT IS THE RESPONSIBILITY OF NICOR GAS TO ASSURE THAT NECESSARY WIPE TESTS ARE CONDUCTED AS REQUIRED BY FEDERAL REGULATIONS.

DRAWING - SHEET	DESCRIPTION
C15321C-01	COVER PAGE
C15321C-02	SITE PLAN, SYMBOL LEGEND, & TEST DATA
C15321C-03	N ROY AVENUE & E PALMER AVENUE
C15321C-04	DETAIL 'A'
C15321C-05	N ROY AVENUE & E DICKENS AVENUE
C15321C-06	N ROY AVENUE & VILLAGE DRIVE
C15321C-07	E DICKENS AVENUE
C15321C-08	E DICKENS AVENUE & N MCLEAN AVENUE
C15321C-09	E DICKENS AVENUE & N ROBERTA AVENUE
C15321C-10	E DICKENS AVENUE
C15321C-11	E DICKENS AVENUE
C15321C-12	E MAJOR DRIVE
C15321C-13	E MAJOR DRIVE & N MCLEAN AVENUE
C15321C-14	E MAJOR DRIVE & N ROBERTA DRIVE
C15321C-15	E MAJOR DRIVE
C15321C-16	E MAJOR DRIVE
C15321C-17	E VILLAGE DRIVE & N MCLEAN AVENUE
C15321C-18	E VILLAGE DRIVE
C15321C-19	E VILLAGE DRIVE & N ROBERTA DRIVE
C15321C-20	E VILLAGE DRIVE
C15321C-21	N GENEVA AVENUE & E DICKENS AVENUE
C15321C-22	N GENEVA AVENUE & E MAJOR DRIVE
C15321C-23	N GENEVA AVENUE & E VILLAGE DRIVE
C15321C-24	MAINTENANCE OF TRAFFIC STANDARD
C15321C-25	MAINTENANCE OF TRAFFIC STANDARD
C15321C-26	MAINTENANCE OF TRAFFIC STANDARD
C15321C-27	MAINTENANCE OF TRAFFIC STANDARD
C15321C-28	ENVIRONMENTAL SPECIFICATIONS

**COORDINATE WORK WITH
WO 120402, 120408, 120409**

TOTAL WORK ORDER QUANTITIES		
	ESTIMATED	ACTUAL
TOTAL PIPE INSTALLATION*		
2" PIPE IPS PE SDR 11.0	6447'	
4" PIPE IPS PE SDR 11.5	2609'	
6" PIPE IPS PE SDR 13.5	1128'	
8" PIPE X52 FBE DC+IC 0.219" WT	115'	
8" LINE VALVE (G7WH) TAG#	1	
TOTAL PIPE RETIREMENT		
2" STEEL (1940)	878'	
2" STEEL (1941)	7763'	
2" STEEL (1954)	103'	
2" STEEL (1969)	17'	
2" STEEL (1983)	337'	
6" STEEL (1969)	43'	
8" STEEL (1951)	9'	
8" STEEL (1953)	1131'	
8" STEEL (1969)	5'	
TOTAL PIPE BORING		
2" BORING	6277'	
4" BORING	2544'	
6" BORING	1036'	
8" BORING	53'	
TOTAL TRENCH BACKFILL		
	286 C.Y.	
TOTAL ASPHALT & CONCRETE BREAKS		
	2375 S.F.	
TOTAL SERVICE TRANSFERS		
	248	

REQUIRED PERMITS APPROVAL BEFORE CONSTRUCTION	REQUIRED	APPROVED DATE
LAND SERVICES---APPROVAL		
RAILROAD		
HIGHWAY, STATE		
HIGHWAY, COUNTY		
FOREST PRESERVE		
SANITARY DIST.		
PRIVATE PROP. EASEMENT		
FRONTAGE		
OTHER GOV. AGENCY		
ENVIRONMENTAL---APPROVAL		
WATERWAYS		
WETLANDS		
CONTAMINATED SOIL		
STORM WATER		

N
LOCATION MAP
NORTHLAKE, IL
(NOT TO SCALE)

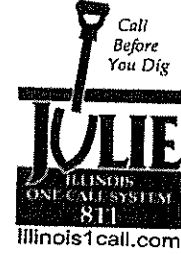
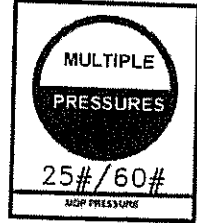

VINTAGE STEEL MAIN REPLACEMENT

SEALED BY: DATE: 02/12/2020 LICENSE EXPIRATION: 11/30/2020	PREPARED BY: Kimley-Horn <small>© 2020 KIMLEY-HORN AND ASSOCIATES, INC. 1707 WAREHOUSING ROAD, SUITE 350, USLE, IL 60532. PHONE: 630-407-5550 WWW.KIMLEY-HORN.COM</small> PREPARED FOR: Nicor Gas	COUNTY: COOK TOWN: NORTHLAKE RANGE: T40N R12E SPM SECTION: J21 J22 SHEET: 1 OF 28
APPROVED FOR CONSTRUCTION		ENGINEER/DESIGNER: J. MEYER DATE: 1/23/2020 CHECKED BY: L. BRADNICK DATE: 01/30/2020 PROJECT NO.: 120407/320407 SHEET NO.: VW180 PROJECT NO.: 120407/320407 SHEET NO.: 1 OF 28 DATE: 02/03/2020 APPROVED BY: D. SMITH DATE: 02/12/2020 DRAWING FILE NO.: C15321C
NOT TO SCALE DATE IN SURFACE		

NICOR GAS - CONSTRUCTION VINTAGE STEEL REPLACEMENT - VW181 VILLAGE DRIVE TO WHITEHALL DRIVE & LAPORTE AVENUE TO N GENEVA AVENUE NORTHLAKE, IL W.O. 120408/320408

INVESTING IN ILLINOIS
A Nicor Gas System Improvement Initiative

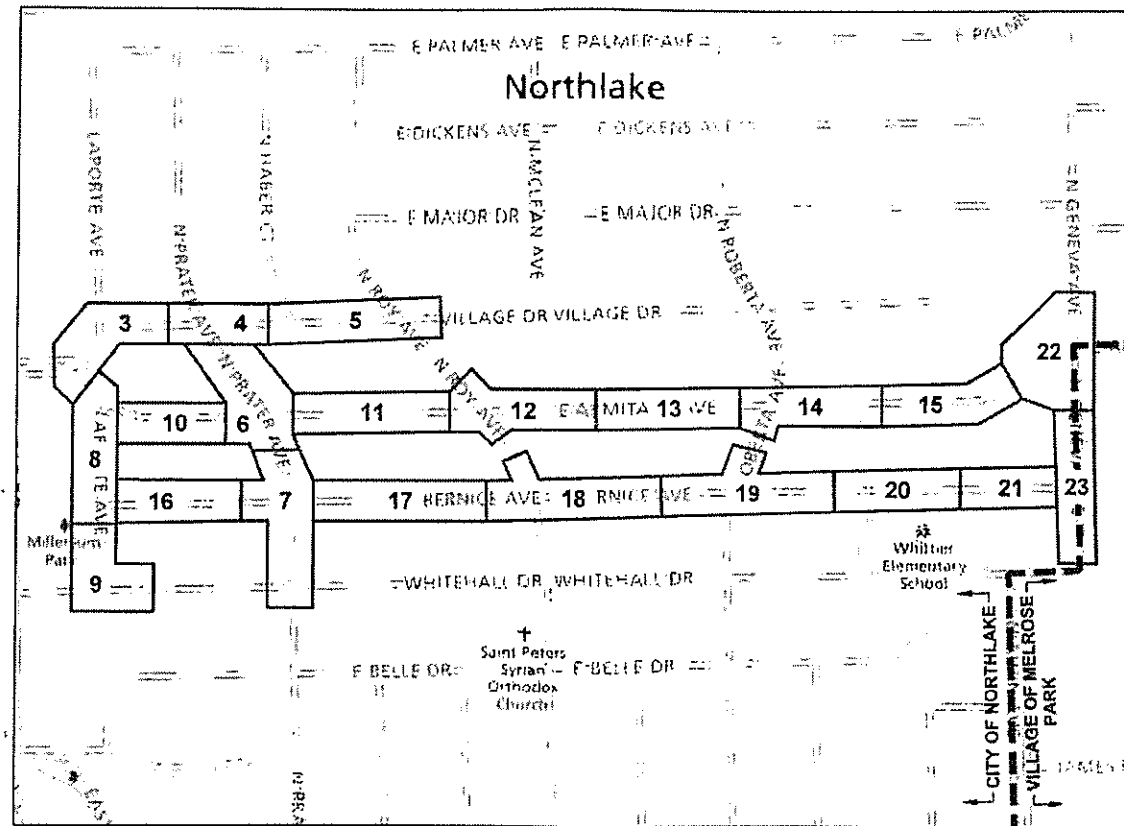

N
LOCATION MAP
NORTHLAKE, IL
(NOT TO SCALE)

These plans and/or supporting documents have been reviewed for compliance with the applicable portions of the municipal codes of the City/Village of **NORTHLAKE**.

This approval does not serve to amend, modify or waive any zoning or other development related requirements.

CHRISTOPHER B. BURKE ENGINEERING LTD.

By: *Robert T. Jungwirth*
DATE: 4-1-2020

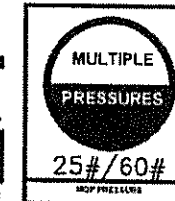
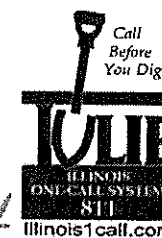

IDENTIFIED BY NICOR UTILITY INSPECTOR					COMPLETED BY NICOR GAS*	
WIPE TEST #	WORK ORDER PAGE	TEST LOCATION	PIPE SIZE	PIPE MATERIAL	DATE TEST COMPLETED	COMMENTS

*TYPICALLY COMPLETED BY UTILITY INSPECTOR
NOTE: NICOR UTILITY INSPECTOR TO IDENTIFY TEST LOCATIONS BASED UPON THE CRITERION OF ONE TEST FOR EACH "CUT AND CAP" ON PIPE THAT MEASURES FOUR INCHES IN DIAMETER OR GREATER. NICOR GAS UNDERSTANDS THAT FIELD PERSONNEL MAY DECIDE TO MOVE "CUT AND CAP" LOCATIONS, DELETE "CUT AND CAPS", OR CONDUCT ADDITIONAL "CUT AND CAPS". NICOR GAS WILL INCLUDE WIPE TESTS AS PART OF THEIR ROUTINES TO COMPLETE A "CUT AND CAP" AND IT IS THE RESPONSIBILITY OF NICOR GAS TO ASSURE THAT NECESSARY WIPE TESTS ARE CONDUCTED AS REQUIRED BY THE FEDERAL REGULATIONS.

DRAWING - SHEET	DESCRIPTION
① C15321C-01	COVER PAGE
② C15321C-02	SITE PLAN, SYMBOL LEGEND & TEST DATA
③ C15321C-03	VILLAGE DRIVE & LAPORTE AVENUE
④ C15321C-04	VILLAGE DRIVE & N PRATER AVENUE
⑤ C15321C-05	VILLAGE DRIVE & N ROY AVENUE
⑥ C15321C-06	N PRATER AVENUE & E ARMITAGE AVENUE
⑦ C15321C-07	N PRATER AVENUE & E BERNICE AVENUE
⑧ C15321C-08	LAPORTE AVENUE & ARMITAGE AVENUE
⑨ C15321C-09	LAPORTE AVENUE & WHITEHALL DRIVE
⑩ C15321C-10	E ARMITAGE AVENUE
⑪ C15321C-11	E ARMITAGE AVENUE
⑫ C15321C-12	E ARMITAGE AVENUE & N ROY AVENUE
⑬ C15321C-13	E ARMITAGE AVENUE
⑭ C15321C-14	E ARMITAGE AVENUE & N ROBERTA AVENUE
⑮ C15321C-15	E ARMITAGE AVENUE
⑯ C15321C-16	E BERNICE AVENUE
⑰ C15321C-17	E BERNICE AVENUE
⑱ C15321C-18	E BERNICE AVENUE & N ROY AVENUE
⑲ C15321C-19	E BERNICE AVENUE & N ROBERTA AVENUE
⑳ C15321C-20	E BERNICE AVENUE
㉑ C15321C-21	E BERNICE AVENUE
㉒ C15321C-22	E GENEVA AVENUE & E ARMITAGE AVENUE
㉓ C15321C-23	E GENEVA AVENUE & E BERNICE AVENUE
㉔ C15321C-24	MAINTENANCE OF TRAFFIC STANDARDS
㉕ C15321C-25	MAINTENANCE OF TRAFFIC STANDARDS
㉖ C15321C-26	MAINTENANCE OF TRAFFIC STANDARDS
㉗ C15321C-27	ENVIRONMENTAL SPECIFICATIONS
㉘ C15321C-28	ENVIRONMENTAL SPECIFICATIONS
㉙ C15321C-29	ENVIRONMENTAL SPECIFICATIONS

COORDINATE WORK WITH
WO 120402, 120407, 120409

VINTAGE STEEL MAIN
REPLACEMENT

REVISION 1

SEAL BY:	SEAL DATE: 02/19/2020	PREPARED BY: Kimley-Horn
DATE EXPIRES: 11/30/2021	PREPARED FOR: Nicor Gas	
APPROVED FOR CONSTRUCTION		
PROJECT NO. 120408/320408	DATE: 01/27/2020	DATE: 01/28/2020
PROJECT NO. VW181	DATE: 01/31/2020	DATE: 02/11/2020
PROJECT NO. 18877000.1.224	DATE: 02/20/2020	DATE: 02/20/2020
PROJECT NO. NOT TO SCALE	DATE: 02/20/2020	DATE: 02/20/2020
PROJECT NO. DATE IN SERVICE	DATE: 02/20/2020	DATE: 02/20/2020

- GENERAL NOTES:**
- CONTRACTOR TO INSTALL THE PROPOSED GAS MAIN TO THE ELEVATIONS SHOWN ON THE PLANS USING THE BENCHMARKS PROVIDED. APPROXIMATE COVER SHOWN AFTER THE REQUIRED ELEVATION IS FOR INFORMATION PURPOSES ONLY.
 - BACKFILL WITH SAND WHERE PIPE TRENCH IS UNDER OR WITHIN 2' OF PAVEMENT, CURB, OR SIDEWALK.
 - INSTALL PROPOSED MAIN USING ROAD STATIONING WHERE GIVEN. OTHER DIMENSIONS ARE FOR MAPPING PURPOSES ONLY.
 - ALL RIGHT-OF-WAY MUST BE STAKED AND STATIONING PROVIDED BEFORE GAS MAIN CAN BE INSTALLED.
 - INSTALL PIPELINE MARKERS PER GCS 249. SEE SPECIFICATION FOR ALL REQUIREMENTS. FOR CLASS 1 AND 2 LOCATIONS, MARKERS ARE REQUIRED OVER EACH BURIED MAIN AT EACH CROSSING OF A PUBLIC ROAD AND RAILROAD. IN ADDITION, PIPELINE MARKERS ARE REQUIRED AT ALL RAILROAD AND WATERWAY CROSSINGS.
 - INSTALL ALL MAIN WITH A MINIMUM COVER OF 3' UNLESS OTHERWISE NOTED.
 - CONTRACTOR SHALL INSTALL THE PROPOSED GAS MAINS CROSSING CONCRETE, ASPHALT, MACADAM, OR OTHER HARD SURFACED PAVEMENTS, WALKS, OR DRIVEWAYS BY BORING OR PUSHING UNLESS OTHERWISE SPECIFIED. CONTRACTOR WILL INSTALL A TEMPORARY PATCH PER GAS CONSTRUCTION SPECIFICATIONS FOR CONTRACTORS. PERMANENT REPAIRS TO BE COMPLETED BY OTHERS.
 - CONTRACTOR SHALL FURNISH AND INSTALL ALL CAPS AND OTHER FITTINGS NECESSARY FOR TESTING THE MAIN.
 - ALL 8" AND LARGER STEEL PIPE THAT IS BORED MUST BE DUAL COATED.
 - PLUG AND/OR CAP RETRIEVED 8" AND LARGER MAINS EVERY 600' PER GCS 849.
 - RETRIEVE OLD MAIN PER GCS 849.
 - IT IS THE RESPONSIBILITY OF THE NICOR GAS INSPECTOR, CONTRACTOR, AND ANYONE INVOLVED IN THE CONSTRUCTION OF THE FACILITIES TO FOLLOW THE LATEST NICOR GAS GAS AND GCS SPECIFICATIONS. CONTACT NICOR'S TECHNICAL SERVICES DEPARTMENT FOR A COPY OF THE LATEST EDITION.
 - COORDINATE WITH NICOR GAS INSPECTOR FOR LOCATION OF UNDERGROUND UTILITIES PRIOR TO STARTING ANY EXCAVATION. EXERCISE CARE WHEN EXCAVATING NEAR EXISTING STRUCTURES.
 - ANY PROPOSED DIRECTIONALLY BORED PIPE TO BE INSTALLED PER NICOR GAS DIRECTIONAL BORING GUIDELINES DATED DECEMBER 15, 2005.
 - UTILITY LOCATIONS SHOWN ON PLANS ARE APPROXIMATE AND MAY NOT BE ALL INCLUSIVE. CONTRACTOR SHALL CONTACT JULIE AND LOCAL GOVERNMENT AGENCIES PRIOR TO CONSTRUCTION FOR ALL UTILITY LOCATIONS.
 - REMOVE TOP SECTION OF THE VALVE BOX FROM VALVES ON THE RETIRED MAIN, BACKFILL WITH SAND AND MATCH EXISTING PAVEMENT IF APPLICABLE.
 - IT IS THE RESPONSIBILITY OF THE CREW (INTERNAL OR CONTRACTOR) INSTALLING THE GAS FACILITIES TO LOCATE ALL SEWER MAINS AND LATERALS WITHIN THE SCOPE OF THE PROJECT. NO BORING, DIRECTIONAL DRILLING OR OTHER TRENCHLESS CONSTRUCTION METHODS SHALL BE EMPLOYED WITHOUT EITHER LOCATING SEWERS OR OBTAINING PROOF OF SEWER SYSTEMS. THE USE OF A SONDE DEVICE (CALIBRATED DAILY) IS RECOMMENDED FOR LOCATING THE SEWER FACILITIES. SPOTTING OF SEWER FACILITIES IS REQUIRED IF A SONDE DEVICE IS NOT USE (HOWEVER, SPOTTING OF FACILITIES MAY STILL BE REQUIRED WHEN USING A SONDE DEVICE). PROPER CLEARANCE OF GAS FACILITIES AND SEWER MAINS/LATERALS SHALL BE MAINTAINED PER GCS 700 SECTION 10.
 - CONTACT INFO:
FRANK TAZELLO
NICOR CONSTRUCTION OPERATIONS SUPERINTENDENT
PHONE: (815) 261-9418
EMAIL: FTAZELLO@SOUTHGAS.COM
 - DALE ROBERTS
CITY OF NORTHLAKE PUBLIC WORKS SUPERINTENDENT
PHONE: (708) 562-0240
EMAIL: DRROBERTS@NORTHLAKECITY.COM

- ENVIRONMENTAL NOTES:**
- PCB WIPE SAMPLES, PERFORMED BY NICOR GAS EMPLOYEES, ARE REQUIRED FOR ALL 4" AND LARGER PIPE THAT IS ABANDONED OR REMOVED ON THIS WORK ORDER. DIRECT QUESTIONS ON PCB WIPE SAMPLE PROCEDURES TO THE SYSTEM OPERATIONS DEPARTMENT OR KEITH BOODER (630-514-7589) IN ENVIRONMENTAL AFFAIRS (EA).
 - COLLECT AND PROPERLY DISPOSE OF ALL LIQUIDS FROM PIPELINES BEING RETIRED.
 - IN THE EVENT OF A SPILL, PLEASE IMMEDIATELY CALL DISPATCH (630-317-9111) AND ASK FOR THE ON-CALL ENVIRONMENTAL REPRESENTATIVE.
 - ANY RETIRED PIPE THAT MUST BE REMOVED FROM THE SITE SHOULD HAVE THE ENDS COVERED WITH PLASTIC OR SIMILAR MATERIAL UNTIL THE PCB WIPE SAMPLE LAB RESULTS ARE KNOWN. INDICATE ON THE NICOR GAS PCB SAMPLE INFORMATION FORM WHERE ANY PIPE REMOVED FROM THE SITE IS BEING TEMPORARILY LOCATED.
 - IF ASBESTOS CONTAMINATION IS IDENTIFIED, REFER TO ASBESTOS CONTROL PLAN REMOVAL GUIDELINES. REMOVAL MUST BE COMPLETED BY A TRAINED EMPLOYEE, FOR ANY QUESTIONS OF PROCEDURE OR TRAINED EMPLOYEES, CALL SCOTT MURPHY (630-392-7033) IN THE SAFETY DEPT.
 - IF CONTAMINATED SOIL IS SUSPECTED, CALL KEITH BOODER (630-514-7589) IN EA FOR REGULATORY COMPLIANCE INSTRUCTIONS.
 - ALL WETLANDS SHOULD BE IDENTIFIED ON THESE WORK ORDER DRAWINGS. WETLANDS AND WATERBODIES ARE GENERALLY LABELED AS "SITES," IF THERE IS A QUESTION ABOUT THE WETLAND BOUNDARIES OR BUFFERS, PLEASE CALL EA (JULIE PASCHAL AT 630-392-7013 OR ALICIA BISHOP 224-268-7283).
 - IF THE PROJECT HAS ENVIRONMENTAL PERMITS AND/OR A GREEN BINDER, THE CONTRACTOR IS RESPONSIBLE FOR FOLLOWING THE NICOR GAS STORM WATER POLLUTION PREVENTION PLAN FOR THE PROJECT. IF THERE ARE QUESTIONS, PLEASE CALL EA (JULIE PASCHAL AT 630-392-7013 OR ALICIA BISHOP 224-268-7283).
 - IF A FRAC OUT OCCURS DURING DIRECTIONAL DRILLING, THE CONTRACTOR IS RESPONSIBLE FOR STOPPING THE BORE, CONTAINING THE FRAC OUT MATERIAL, AND IMMEDIATELY CONTACTING EA (JULIE PASCHAL AT 630-392-7013 OR ALICIA BISHOP 224-268-7283). AFTER CONTAINING THE MATERIAL AND CONTACTING EA, THE CONTRACTOR MUST REMOVE THE FRAC OUT MATERIAL.
 - REFUEL AND STORE EQUIPMENT A MINIMUM OF 100 FEET FROM WETLANDS OR WATER BODIES.
 - INSTALL SOIL AND EROSION CONTROL PROTECTION TO PROTECT ANY OPEN GRATED STRUCTURES, I.E. INLETS, CATCH BASINS, OR MARKERS WITHIN OR ADJACENT TO THE PROJECT AREA THAT ARE NEAR DISTURBED SOIL.
 - WHEN DOWNGRADING, DIRECT WATER TO A FLAT, UPLAND AREA TO ALLOW WATER TO SOAK INTO THE GROUND AND/OR USE FILTER BAGS AND WOOD FIBER LOGS TO REMOVE SOIL/SEDIMENT FROM THE WATER. NO SEDIMENT LOADED WATER IS ALLOWED TO ENTER INLETS, WETLANDS, WATER BODIES, ETC.
 - IF MUD IS BEING TRACKED ON THE STREETS BY EQUIPMENT AND/OR VEHICLES, DAILY STREET SWEEPING WILL BE REQUIRED.
 - ALL DISTURBED AREAS SHALL BE RESTORED TO ORIGINAL CONTOURS AND CONDITIONS. RESTORATION MUST BE INITIATED WITHIN 1 DAY DEPENDING ON PERMIT CONDITIONS.

No error, omission, or discrepancy of any sort in either the plans and/or supporting documents (whether said plans or documents have been reviewed by the Municipal Engineer or not) shall permit or release the applicant from constructing this work in any other manner than that provided for in the ordinance of this Municipality relating thereto.

TOTAL WORK ORDER QUANTITIES		
TOTAL PIPE INSTALLATION	ESTIMATED	ACTUAL
2" PIPE IPS PE SDR 11.0	8750'	
4" PIPE IPS PE SDR 11.5	600'	
6" PIPE IPS PE SDR 13.5	1676'	
TOTAL PIPE RETIREMENT	ESTIMATED	ACTUAL
2" STEEL (1940)	4924'	
2" STEEL (1941)	3997'	
2" STEEL (1953)	1675'	
2" STEEL (1983)	256'	
2" STEEL (1984)	206'	
2" STEEL (2002)	44'	
8" STEEL (1953)	1675'	
TOTAL PIPE BORING	ESTIMATED	ACTUAL
2" BORING	8449'	
4" BORING	576'	
6" BORING		
TOTAL TRENCH BACKFILL	259 C.Y.	
TOTAL ASPHALT & CONCRETE BREAKS	2100 S.F.	
TOTAL SERVICE TRANSFERS	226	

REQUIRED PERMITS APPROVAL BEFORE CONSTRUCTION	REQUIRED	APPROVED DATE
LAND SERVICES --- APPROVAL		
RAILROAD		
HIGHWAY, STATE		
HIGHWAY, COUNTY		
FOREST PRESERVE		
SANITARY DIST.		
PRIVATE PROP. EASEMENT		
FRONTAGE		
OTHER GOV. AGENCY		
ENVIRONMENTAL --- APPROVAL		
WATERWAYS		
WETLANDS		
CONTAMINATED SOIL		
STORM WATER		

